

COPPER TUBE CRIMPING LUG TYPE AM for copper conductors



Description:

- A-M series lugs are manufactured from electrolytic copper tube Cu-OF CW008A conform to UNI EN 13600:2013. The dimensions of the tube are designed to obtain the most efficient electrical conductivity and mechanical strength to resist vibration and pull out.
- Cembre lugs are annealed to guarantee optimum ductility which is an absolute necessity for connectors which will have to withstand the severe deformation arising when compressed and any bending of the palm during installation.
- In applications subject to vibration, terminals still have to perform a reliable connection, annealing plays a vital role in avoiding cracking or breaks between the barrel and palm.
- The presence of an inspection hole facilitates full insertion of the conductor, whilst the barrel length has been designed to allow easy and accurate positioning of the dies during the crimping operation.
- Lugs are electrolytically tin plated with a minimum thickness of 3µm to avoid oxidation. A-M series lugs form an important part of Cembre crimping systems for power carrying conductors.

Each connector is marked as follows:

- Cembre trade mark and reference number.
- Nature and size of conductor (mm²).
- Ø stud (mm).

Markings:



- According to UL 486A standard (file E125401)

File no. E125401

Cembre SpA

Via Serenissima, 9 - 25135 Brescia (Italy)

Tel.: +39 030 36921 - Fax: +39 030 3365766

Web: www.cembre.com - Email: info@cembre.com

COPPERTUBE CRIMPING LUGTYPE AM
for copper conductors

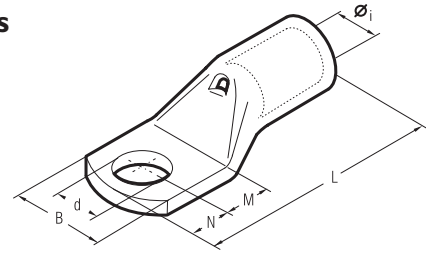

Sections and Dimensions:

Cond. Size sqmm <small>low stranded</small> <small>flexible*</small>	Ø Stud mm	Ref.	Dimensions mm					
			Øi	B	M	N	L	d
0,25÷1,5	3	A 03-M 3♦	1,8	6,0	4,5	3,5	16,0	3,2
	3,5	A 03-M 3,5♦	1,8	6,5	4,5	3,5	16,0	3,7
	4	A 03-M 4♦	1,8	6,5	5,0	4,0	17,0	4,3
	5	A 03-M 5♦	1,8	7,5	5,5	4,5	18,0	5,3
	6	A 03-M 6♦	1,8	9,0	6,0	5,0	19,0	6,4
1,5÷2,5	3	A 06-M 3♦	2,4	6,0	4,5	3,5	17,0	3,2
	3,5	A 06-M 3,5♦	2,4	6,5	4,5	3,5	17,0	3,7
	4	A 06-M 4♦	2,4	7,5	5,0	4,0	18,0	4,3
	5	A 06-M 5♦	2,4	8,5	5,5	4,5	19,0	5,3
	6	A 06-M 6♦	2,4	9,0	6,0	5,0	20,0	6,4
4÷6	8	A 06-M 8♦	2,4	12,0	9,0	8,0	26,0	8,4
	3	A 1-M 3	3,6	7,5	4,5	3,5	20,5	3,2
	3,5	A 1-M 3,5	3,6	7,5	4,5	3,5	20,5	3,7
	4	A 1-M 4	3,6	8,0	5,0	4,0	21,5	4,3
	5	A 1-M 5	3,6	9,0	6,5	6,0	25,0	5,3
10	6	A 1-M 6	3,6	11,0	7,0	6,0	25,5	6,4
	8	A 1-M 8	3,6	14,0	9,0	8,0	29,5	8,4
	10	A 1-M 10	3,6	16,5	11,0	10,0	33,5	10,5
	4	A 2-M 4	4,6	10,0	5,0	4,0	22,5	4,3
	5	A 2-M 5	4,6	10,0	6,5	6,0	26,0	5,3
16	6	A 2-M 6	4,6	11,0	7,0	6,0	26,5	6,4
	8	A 2-M 8	4,6	15,0	9,0	8,0	30,5	8,4
	10	A 2-M 10	4,6	18,0	11,0	10,0	34,5	10,5
	12	A 2-M 12	4,6	19,0	14,0	12,0	39,5	13,2
	4	A 3-M 4	5,8	11,5	5,0	4,0	25,5	4,3
25	5	A 3-M 5	5,8	11,5	6,5	6,0	29,0	5,3
	6	A 3-M 6	5,8	11,5	7,0	6,0	29,5	6,4
	8	A 3-M 8	5,8	15,0	9,0	8,0	33,5	8,4
	10	A 3-M 10	5,8	18,0	11,0	10,0	37,5	10,5
	12	A 3-M 12	5,8	20,0	14,0	12,0	42,5	13,2
35	4	A 5-M 4	7,0	14,0	5,0	4,0	28,0	4,3
	5	A 5-M 5	7,0	14,0	6,5	6,0	31,5	5,3
	6	A 5-M 6	7,0	14,0	7,0	6,0	32,0	6,4
	8	A 5-M 8	7,0	15,0	9,0	8,0	36,0	8,4
	10	A 5-M 10	7,0	18,0	11,0	10,0	40,0	10,5
50	12	A 5-M 12	7,0	21,0	14,0	12,0	45,0	13,2
	5	A 7-M 5	8,9	17,0	6,5	6,0	34,0	5,3
	6	A 7-M 6	8,9	17,0	7,0	6,0	34,5	6,4
	8	A 7-M 8	8,9	17,0	9,0	8,0	38,5	8,4
	10	A 7-M 10	8,9	19,0	11,0	10,0	42,5	10,5
70	12	A 7-M 12	8,9	21,0	14,0	12,0	47,5	13,2
	6	A 10-M 6	10,0	19,0	8,0	7,0	38,5	6,4
	8	A 10-M 8	10,0	19,0	9,0	8,0	40,5	8,4
	10	A 10-M 10	10,0	20,0	11,5	9,5	44,5	10,5
	12	A 10-M 12	10,0	21,0	12,0	12,0	47,5	13,2
100	14	A 10-M 14	10,0	25,0	16,0	14,0	55,5	15,0
	16	A 10-M 16	10,0	26,0	18,0	16,0	59,5	17,0
	6	A 14-M 6	11,3	21,0	8,0	7,0	44,0	6,4
	8	A 14-M 8	11,3	21,0	9,0	8,0	46,0	8,4
	10	A 14-M 10	11,3	21,0	11,0	10,0	50,0	10,5
160	12	A 14-M 12	11,3	22,0	14,0	12,0	55,0	13,2
	14	A 14-M 14	11,3	25,0	16,0	14,0	59,0	15,0
	16	A 14-M 16	11,3	26,0	18,0	16,0	63,0	17,0

Cond. Size sqmm <small>low stranded</small> <small>flexible*</small>	Ø Stud mm	Ref.	Dimensions mm						
			Øi	B	M	N	L	d	
70	6	A 19-M 6	13,5	25,0	8,0	7,0	50,5	6,4	
	8	A 19-M 8	13,5	25,0	9,0	8,0	52,5	8,4	
	10	A 19-M 10	13,5	25,0	11,0	10,0	56,5	10,5	
	95	12	A 19-M 12	13,5	25,0	14,0	12,0	61,5	13,2
		14	A 19-M 14	13,5	25,0	16,0	14,0	65,5	15,0
16		A 19-M 16	13,5	27,0	18,0	16,0	69,5	17,0	
20		A 19-M 20	13,5	29,5	22,0	20,0	77,5	21,0	
120		8	A 24-M 8	15,2	28,5	9,0	8,0	54,0	8,4
	10	A 24-M 10	15,2	28,5	11,0	10,0	58,0	10,5	
	120	12	A 24-M 12	15,2	28,5	14,0	12,0	63,0	13,2
		14	A 24-M 14	15,2	28,5	16,0	14,0	67,0	15,0
		16	A 24-M 16	15,2	28,5	18,0	16,0	71,0	17,0
20		A 24-M 20	15,2	30,0	22,0	20,0	79,0	21,0	
150	8	A 30-M 8	16,7	31,5	13,0	11,0	69,0	8,4	
	10	A 30-M 10	16,7	31,5	13,0	11,0	69,0	10,5	
	150	12	A 30-M 12	16,7	31,5	16,0	14,0	75,0	13,2
		14	A 30-M 14	16,7	31,5	18,0	16,0	79,0	15,0
		16	A 30-M 16	16,7	31,5	19,0	17,0	81,0	17,0
20		A 30-M 20	16,7	31,5	22,0	20,0	87,0	21,0	
185	8	A 37-M 8	19,2	35,5	13,0	11,0	76,0	8,4	
	10	A 37-M 10	19,2	35,5	13,0	11,0	76,0	10,5	
	185	12	A 37-M 12	19,2	35,5	16,0	14,0	82,0	13,2
		14	A 37-M 14	19,2	35,5	18,0	16,0	86,0	15,0
		16	A 37-M 16	19,2	35,5	19,0	17,0	88,0	17,0
20		A 37-M 20	19,2	35,5	22,0	20,0	94,0	21,0	
240	8	A 48-M 8	21,1	39,0	13,0	11,0	77,5	8,4	
	10	A 48-M 10	21,1	39,0	13,0	11,0	77,5	10,5	
	240	12	A 48-M 12	21,1	39,0	14,0	12,0	79,5	13,2
		14	A 48-M 14	21,1	39,0	18,0	16,0	92,0	15,0
		16	A 48-M 16	21,1	39,0	19,0	17,0	94,0	17,0
20		A 48-M 20	21,1	39,0	22,0	20,0	100,0	21,0	
300	10	A 60-M 10	23,7	44,0	20,0	11,0	96,0	10,5	
	12	A 60-M 12	23,7	44,0	20,0	14,0	99,0	13,2	
	300	14	A 60-M 14	23,7	44,0	22,0	16,0	103,0	15,0
		16	A 60-M 16	23,7	44,0	22,0	19,0	106,0	17,0
		20	A 60-M 20	23,7	44,0	24,0	23,0	112,0	21,0
400		12	A 80-M 12	27,0	51,0	22,0	19,0	113,0	13,2
	14	A 80-M 14	27,0	51,0	22,0	19,0	113,0	15,0	
	400	16	A 80-M 16	27,0	51,0	22,0	19,0	113,0	17,0
		20	A 80-M 20	27,0	51,0	24,0	23,0	119,0	21,0
		16	A 100-M 16	30,3	56,5	22,0	19,0	117,0	17,0
500	500	A 100-M 20	30,3	56,5	24,0	23,0	123,0	21,0	
	630	500	A 120-M 16♦	33,4	61,6	22,0	19,0	128,0	17,0
630		A 120-M 20♦	33,4	61,6	24,0	23,0	134,0	21,0	
800	16	A 160-M 16♦	38,0	72,0	24,0	19,0	141,0	17,0	
	20	A 160-M 20♦	38,0	72,0	24,0	23,0	145,0	21,0	
1000	16	A 200-M 16♦	44,0	80,0	24,0	19,0	158,0	17,0	
	20	A 200-M 20♦	44,0	80,0	24,0	23,0	162,0	21,0	

*Actual conductor section may require a larger lug eg for 120 mm² size use A30-... lug.

♦Not UL approved

Cembre SpA

Via Serenissima, 9 - 25135 Brescia (Italy)

Tel.: +39 030 36921 - Fax: +39 030 3365766

Web: www.cembre.com - Email: info@cembre.com